

azbil

SMART VALVE POSITIONER

Makes your plant control smarter





In an industrial plant,

It is important
that you are able to operate as planned.



Control valves play a critical role in plant operation.

Stable and reliable valve positioning is key for planned operation

Plant Managers face lots of issues...

Valve troubles...

Complicated on-site works...

Increasing cost...

**Is there a solution for
all of these?**



Introducing

azbil

SMART VALVE POSITIONER



History and Lineup

Valve Positioner by **azbil**

2016~



Smart ESD Device 700 Series
Model AVP77*/78*/79*

2014~



Smart Valve Positioner 700 Series
Model AVP701/702/703

1998~



Smart Valve Positioner 300 Series
Model AVP300/301/302

2000~



Smart Valve Positioner 200 Series
Model AVP200/201/202

2002~



Smart Valve Positioner for Rotary Valve
Model SVX100/102

1985~



Electro-Pneumatic Valve Positioner
Model HEP15/17/18/19/25/28/29

1958~

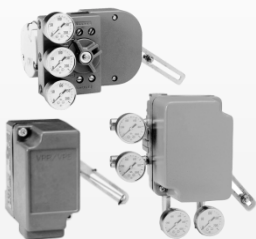

Pneumatic Valve Positioner
Model HTP, VPP02/03/08
Model VPE04/05, VPP02/03



Higher Reliability



Easy Operation



Cost Reduction



Features



Higher Reliability

High Durability

Stable Operation

Bulkhead Structure

Secured Close-off

Durable Over
50,000,000 Times
Actuation

Realized by a Simple Structure with Less Moving Parts



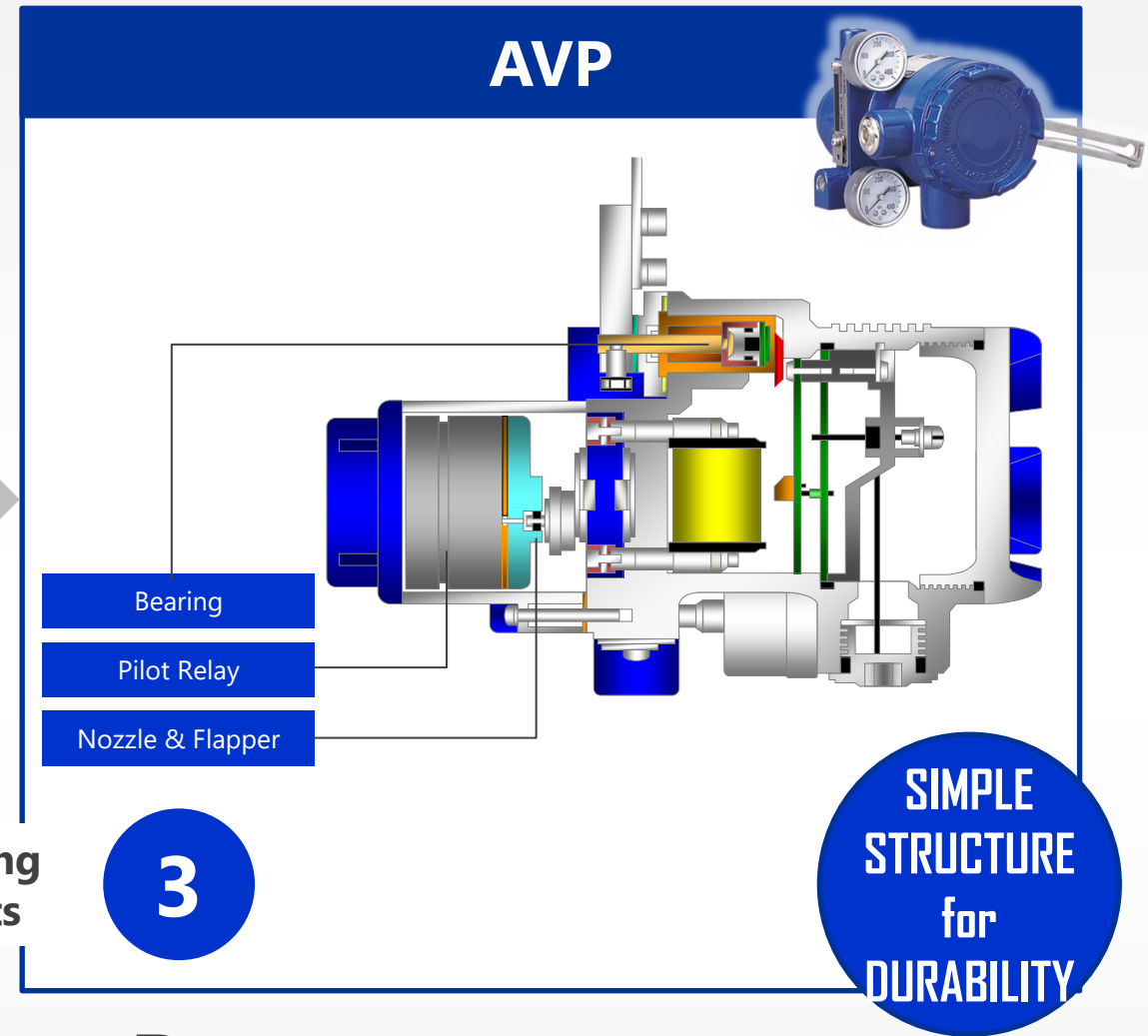
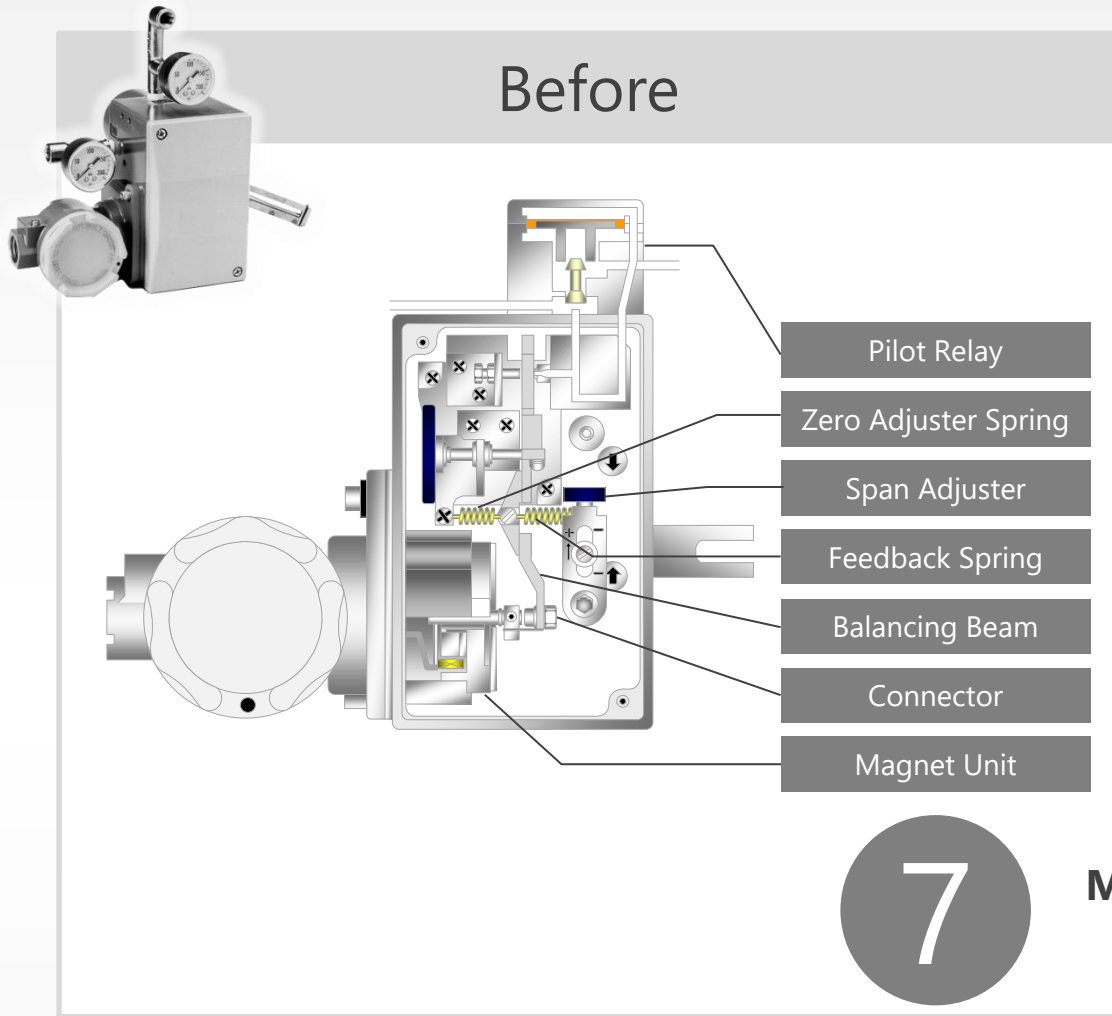

Less Moving Parts

High Durability is achieved by a simple structure

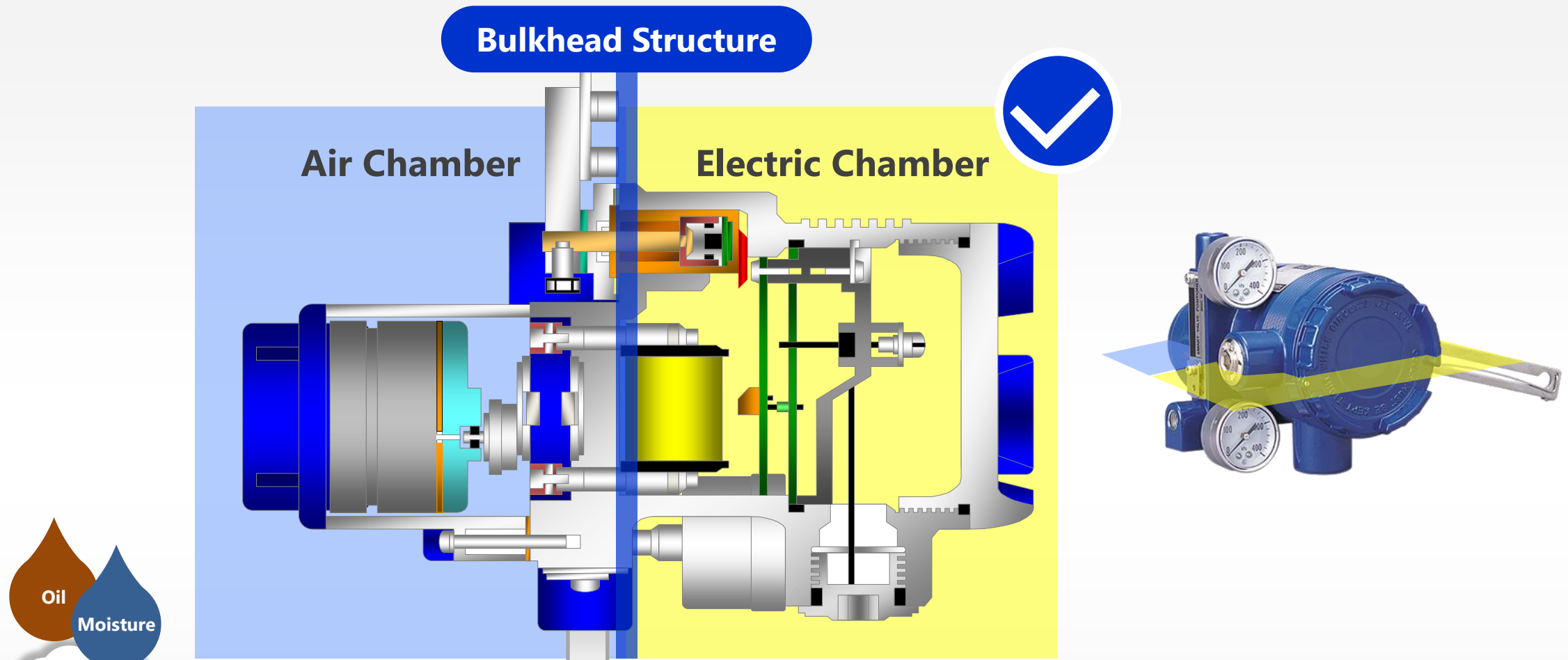

Separate Air and Electric Chambers

Bulkhead structure separates the parts to avoid oil and moisture from air supply

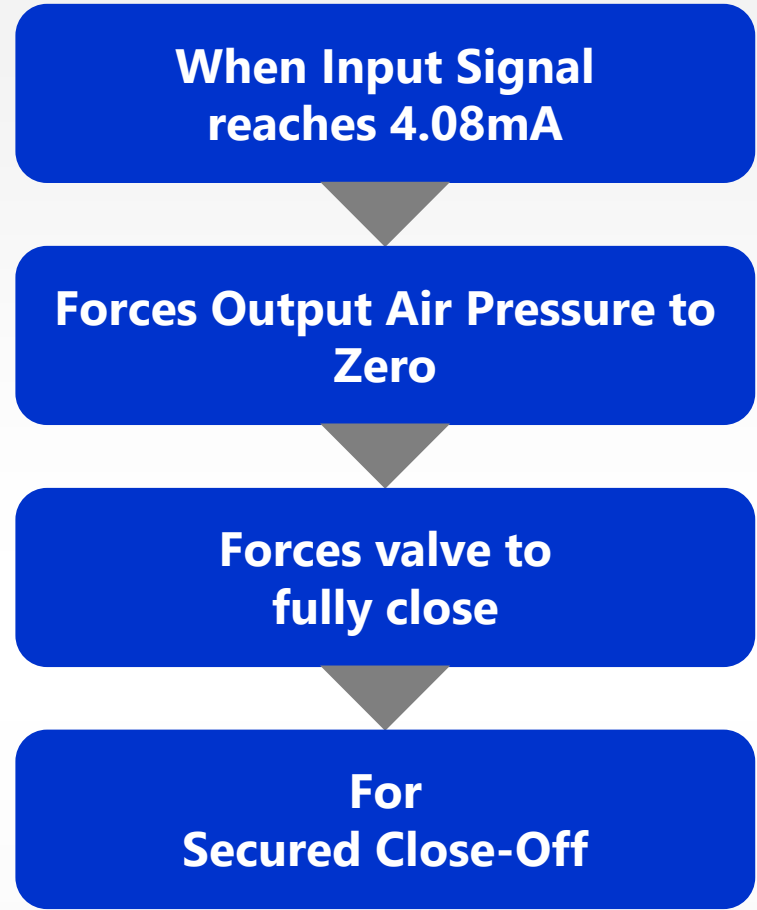
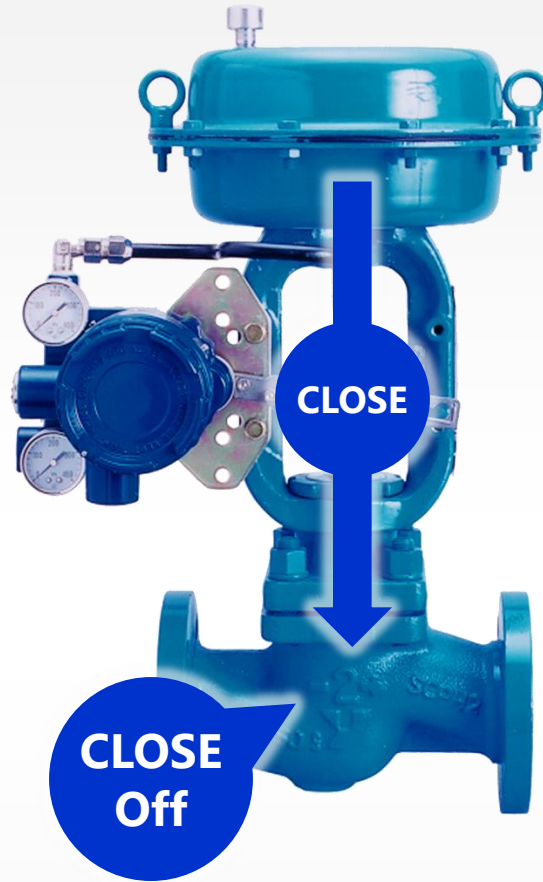
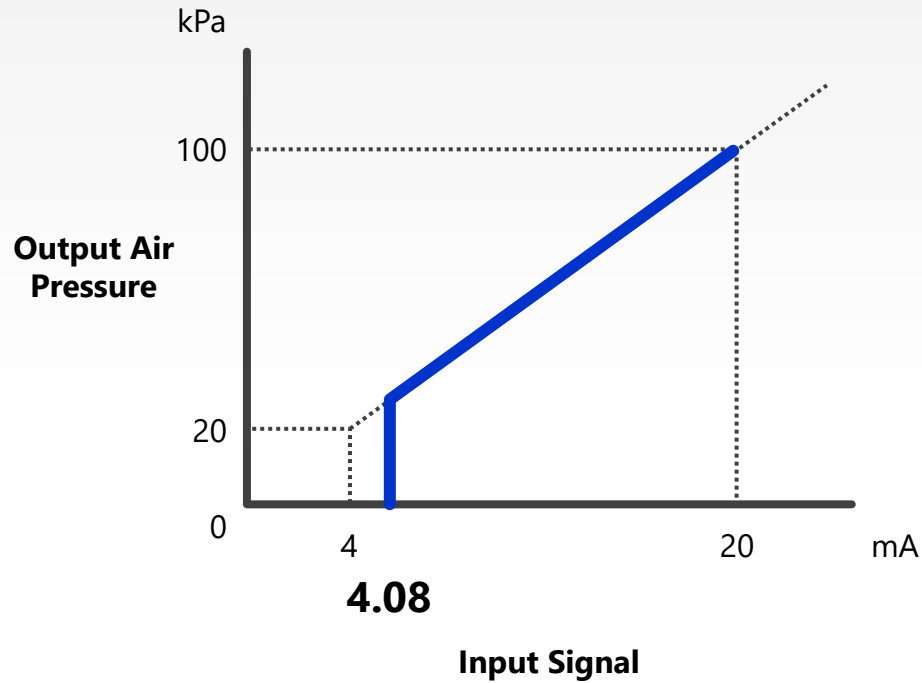

For Secured Close-Off

AVP forces output air pressure to Zero at a desired input signal



Easy Operation

Auto Alignment

Your Side Kick

Free from Vibration

Self Diagnosis

Before



Operation done by
all mechanical parts

AVP

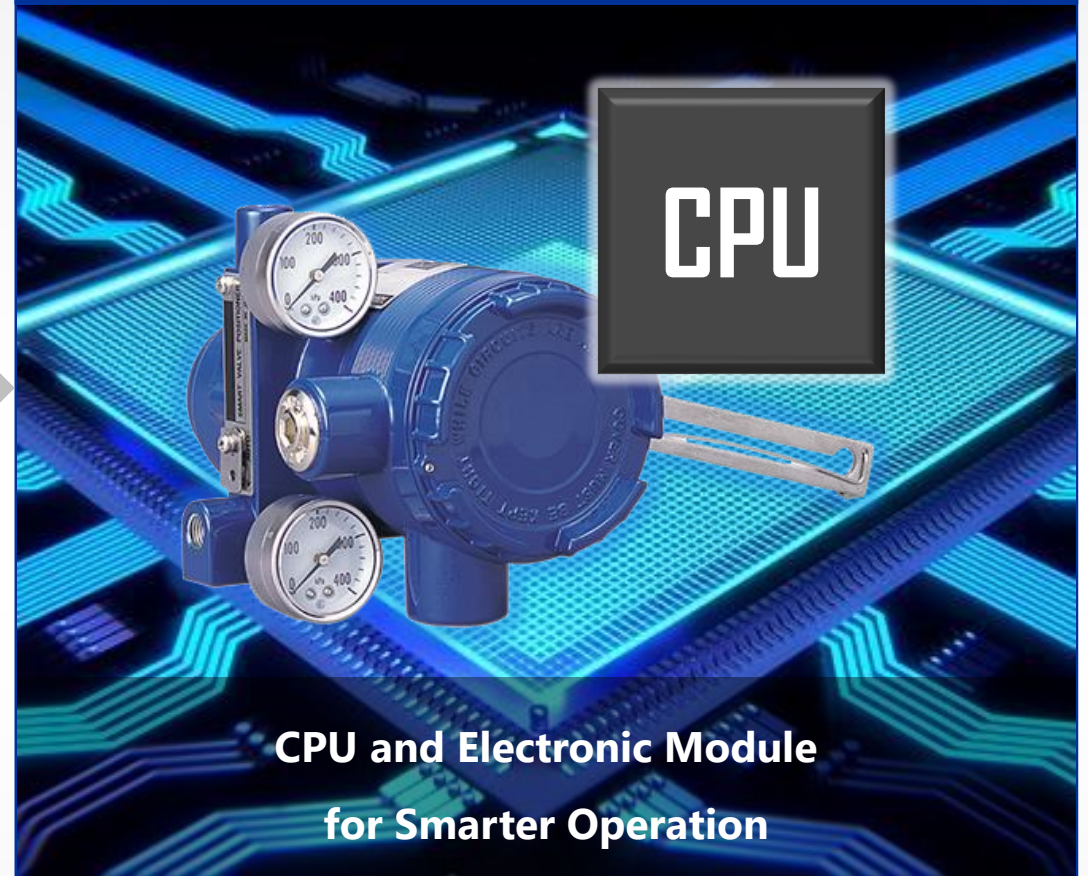

CPU and Electronic Module
for Smarter Operation

AVP is smarter than ever

The CPU inside makes AVP smarter than the mechanical ones

Before



Set zero point

Adjust Span

All Manually

Do it again...

AVP



Turn screw

Done.

AUTO
ALIGNMENT

Alignment done in a Smarter Way

Auto Alignment makes your on-site works much easier

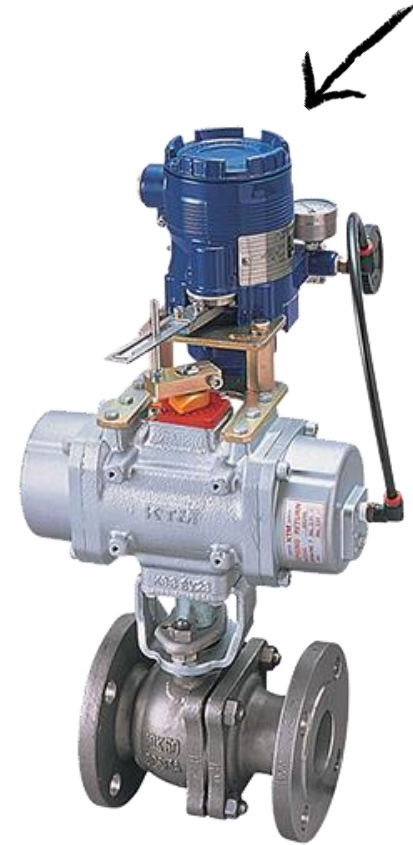
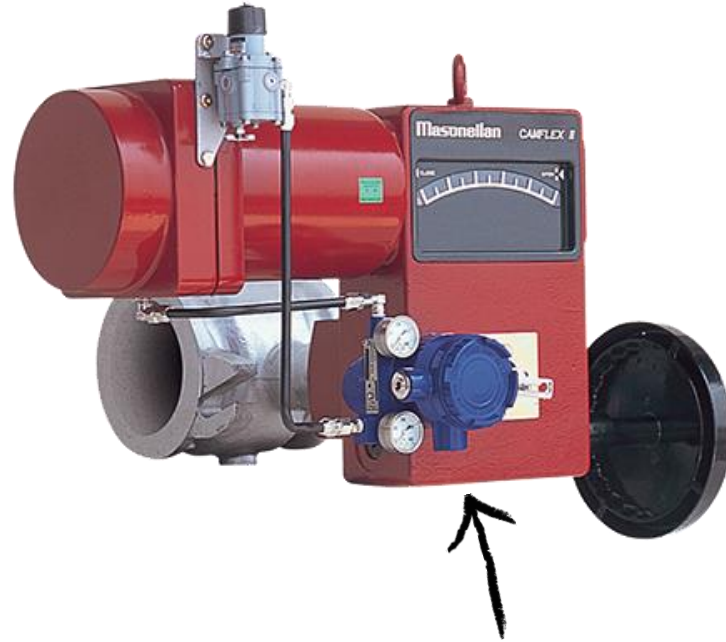

MORE THAN
600
MODELS

AVP, for Your Side Kick

AVP has been installed on more than 600 other companies' Control Valve models

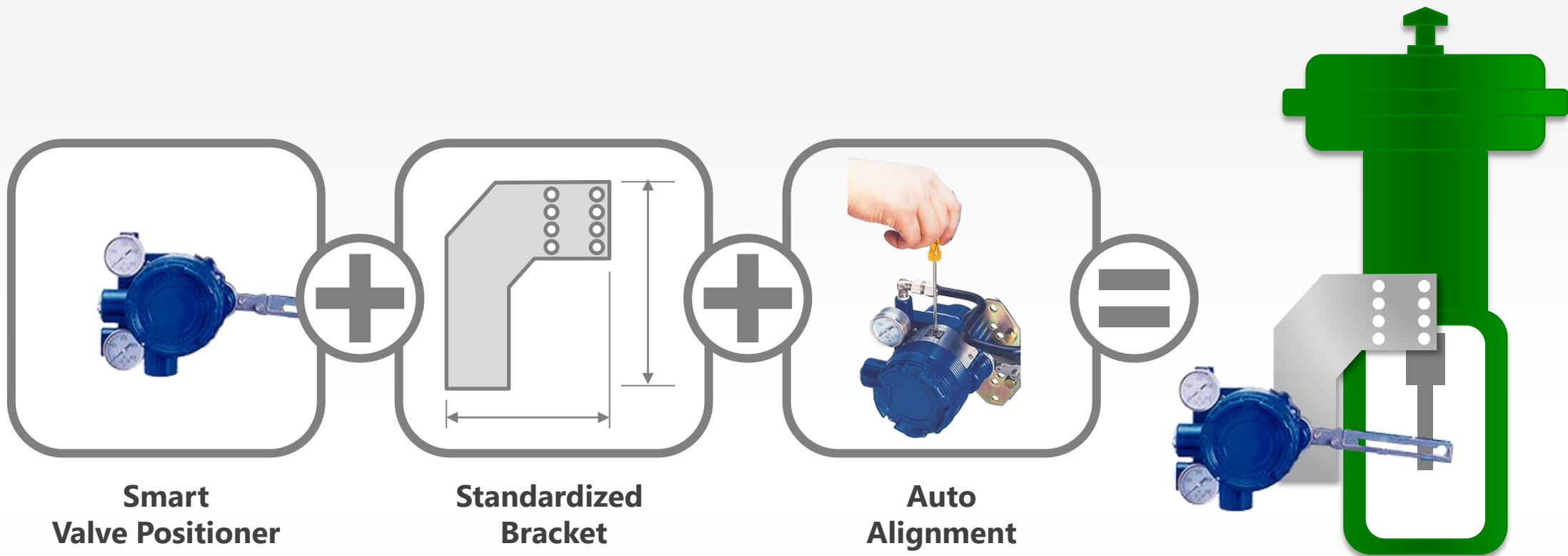

**Smart
Valve Positioner**

**Standardized
Bracket**

**Auto
Alignment**

Everything for Easy Installation

Standardized Bracket and Auto Alignment allows AVP to be easily installed on other valves

Motoyama	2800 Series 240, 280, 330, 400, 500SL, 650S, L	KOSO	AT100 Series 270, 320, 400, 500
	2800 Series 240, 280, 330, 400, 500SL, 650S, L (with Side Handle)		5100L Series 249, 280
	3800 Series N24, N28, N33S		5200LA Series 218, 270, 350
	2992 GYROLL I (G.R. I) 280H, 330H, 400HS, 400HL, 400H, 500H		6300 Series AT Series AT20, 25, 30, 40, 50, 60, 200, 250, 300, 350, 500
	3993 GYROLL II (G.R. II) 2911-1M Series 280, 330, 400, 280H, 330H, 400H		TC-500 Series TC-520S (Single-Acting), TC-520W (Double-Acting)
Dresser	37, 38 Series #9, 11, 13, 15, 18		TC-700 Series TC-713S (Single-Acting), TC-713W (Double-Acting)
	37, 38 Series #15, #18 (with Side Handle)		TC-700 Series TC-722S (Single-Acting)
	35002 Camflex II #4 1/2, #6 (Valve Size 1" ~ 4")	Fisher	657, 667, Series, 40, 45, 50, 60
	35002 Camflex II #7 (Valve Size 6" ~ 12")	Emerson	AK05S, 09S, 12S, 15S, AG06S, 09S, 13S, AW13S, 17S, 20S (Single-Acting)
TOMOE VALVE	Z Series Z06S, 08S, 11S, 13S (Single-Acting)		AK05, 09, 12, 15, AG06, 09, 13, AW13, 17, 20 (Double-Acting)
	Z Series Z06, 08, 11, 13 (Double-Acting)	HISAKA	TS-1, 2, 3, 4, 5, 6 (Single-Acting)
	T-matic 3Q-1, 2, 3, 4 (Single-Acting)	XOMOX	E25, 40, 65, 100, 200, 350, 600, 950, 1600,
	T-matic 3I-1, 2, 3, 4 (Double-Acting)		P2500, 4000 (Single-Acting)
KITZ	BS-1, 2, 3, 4, 5, 6 BSW-1, 2, 3, 4, 5, 6 (Single-Acting)		E25, 40, 65, 100, 200, 350, 600, 950, 1600,
	B-1, 2, 3, 4, 5, 6 (Double-Acting)		P2500, 4000 (Double-Acting)
TV-Valve	AT4-80, 100, 120, 150, 180 (Double-Acting)	METSO	BC Series BC/BIC11
		SOMAS	A22-DA

Over 160 Models, 12 Brands Brackets Standardized

Standardized brackets for AVP already designed to fit these valves

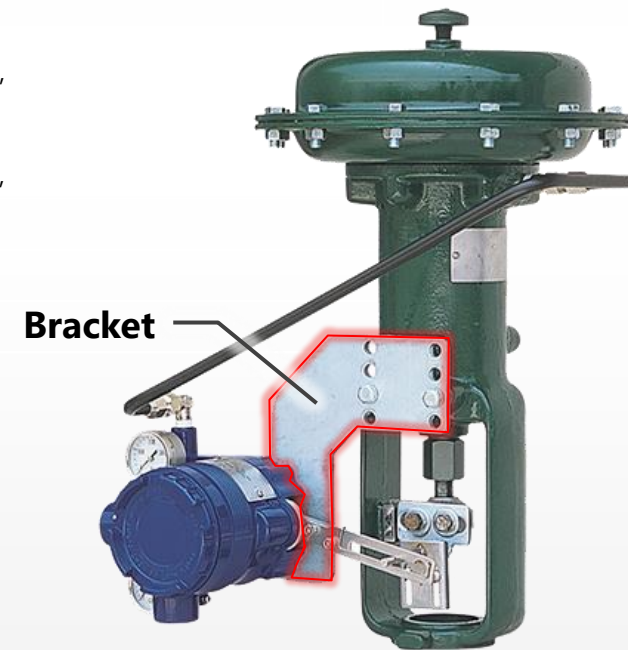



Free from Vibrations

AVP200 separated type can avoid any vibrations from valve body



For your better Working Environment

You can install AVP200 separated type
at a convenient place



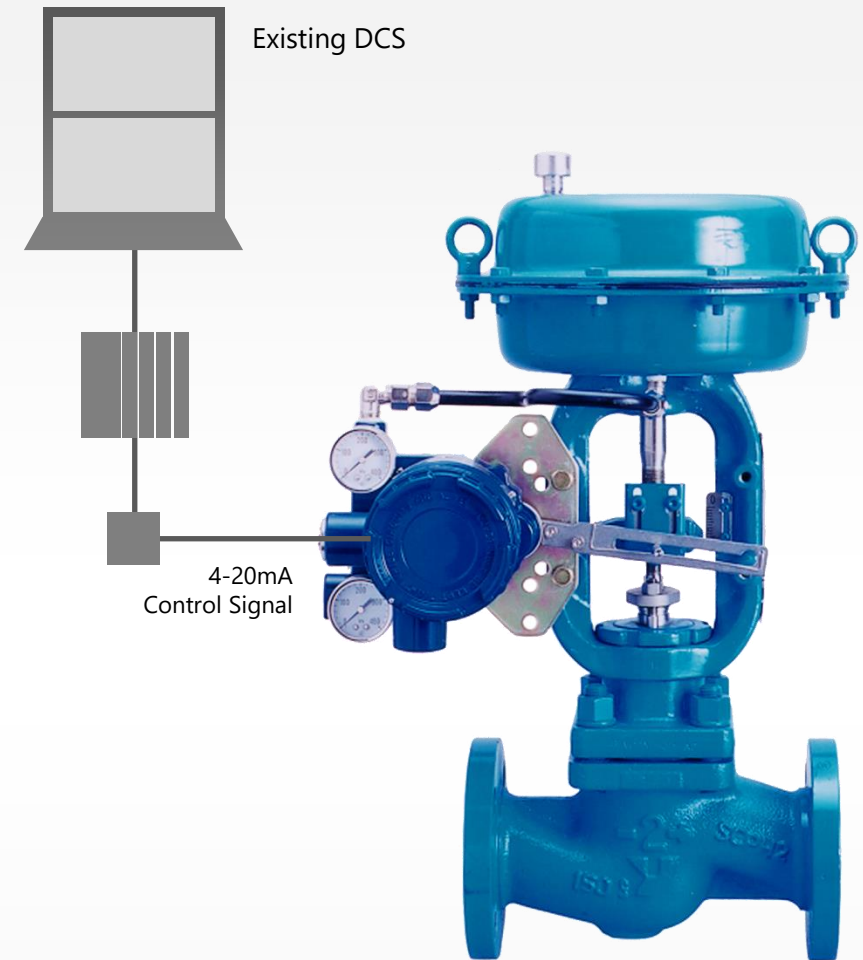
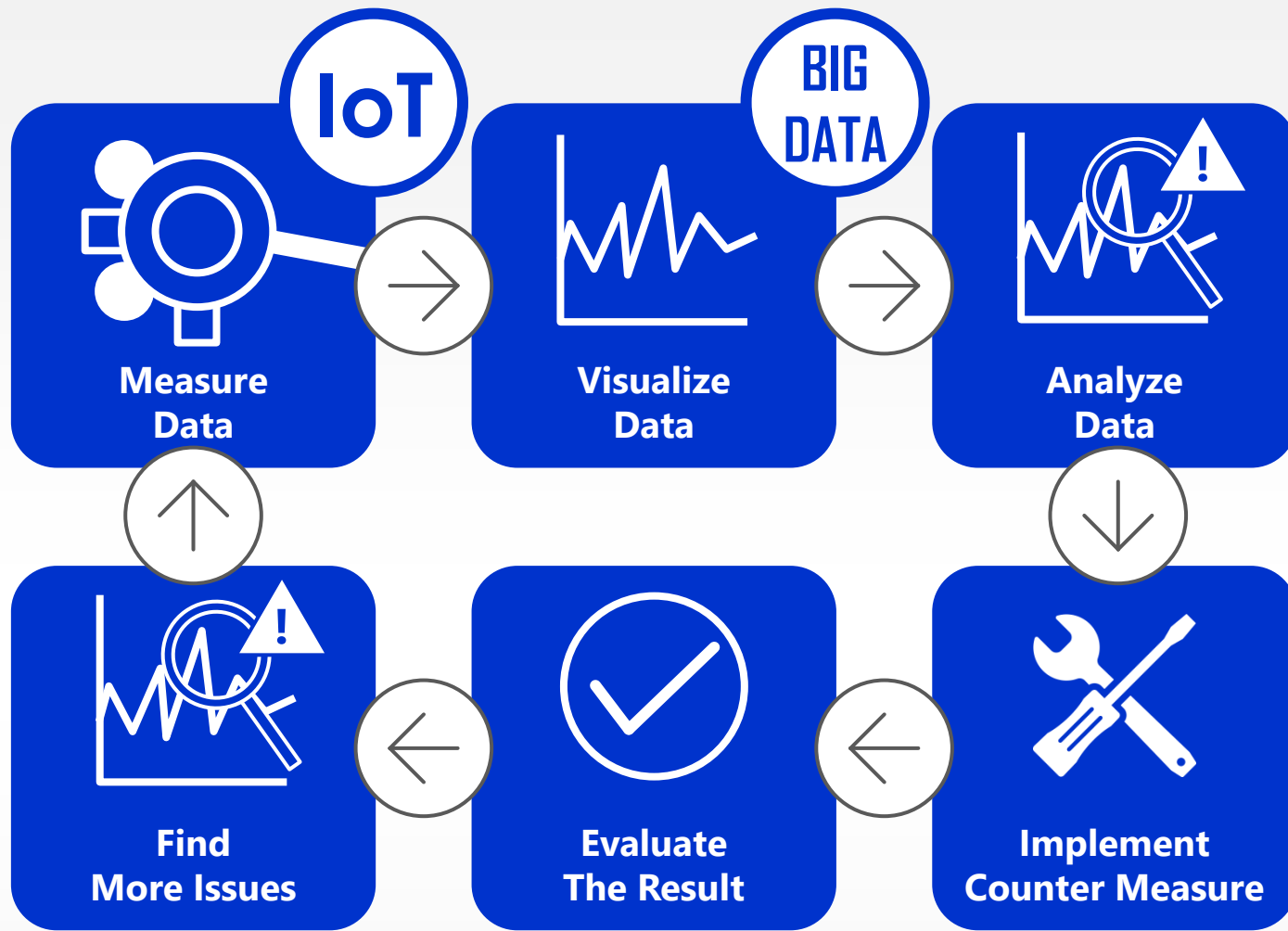

Control Valve Diagnosis

PDCA Cycle to achieve diagnosis

ADD-ON
TO
EXISTING SYSTEM

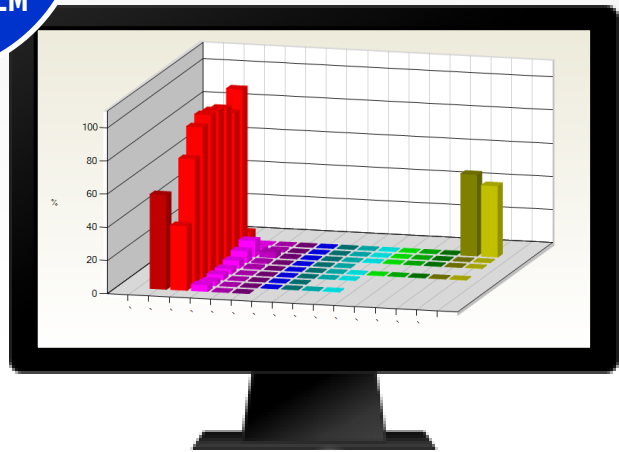

Valstaff

Valve Diagnosis Software



HART
COMMUNICATION PROTOCOL

Data from AVP via HART

Digital communication protocol on 4-20mA signal line

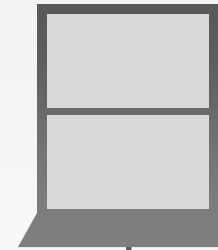

Existing DCS

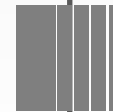

4-20mA
Control Signal



Control Valve Diagnosis

AVP will provide useful data for analysis

Online	Control Valve Trouble	Stick Slip Diagnosis (Azbil Patented) Input Signal/Positioning Gap Zero Point Positioning Comparison
	Control Valve Trend	Moving Distance Accumulation Monitoring Full Close Time Monitoring Actuation Frequency Monitoring
	Positioner	Internal Temperature Monitoring
Offline	Control Valve Test	Step Response Test

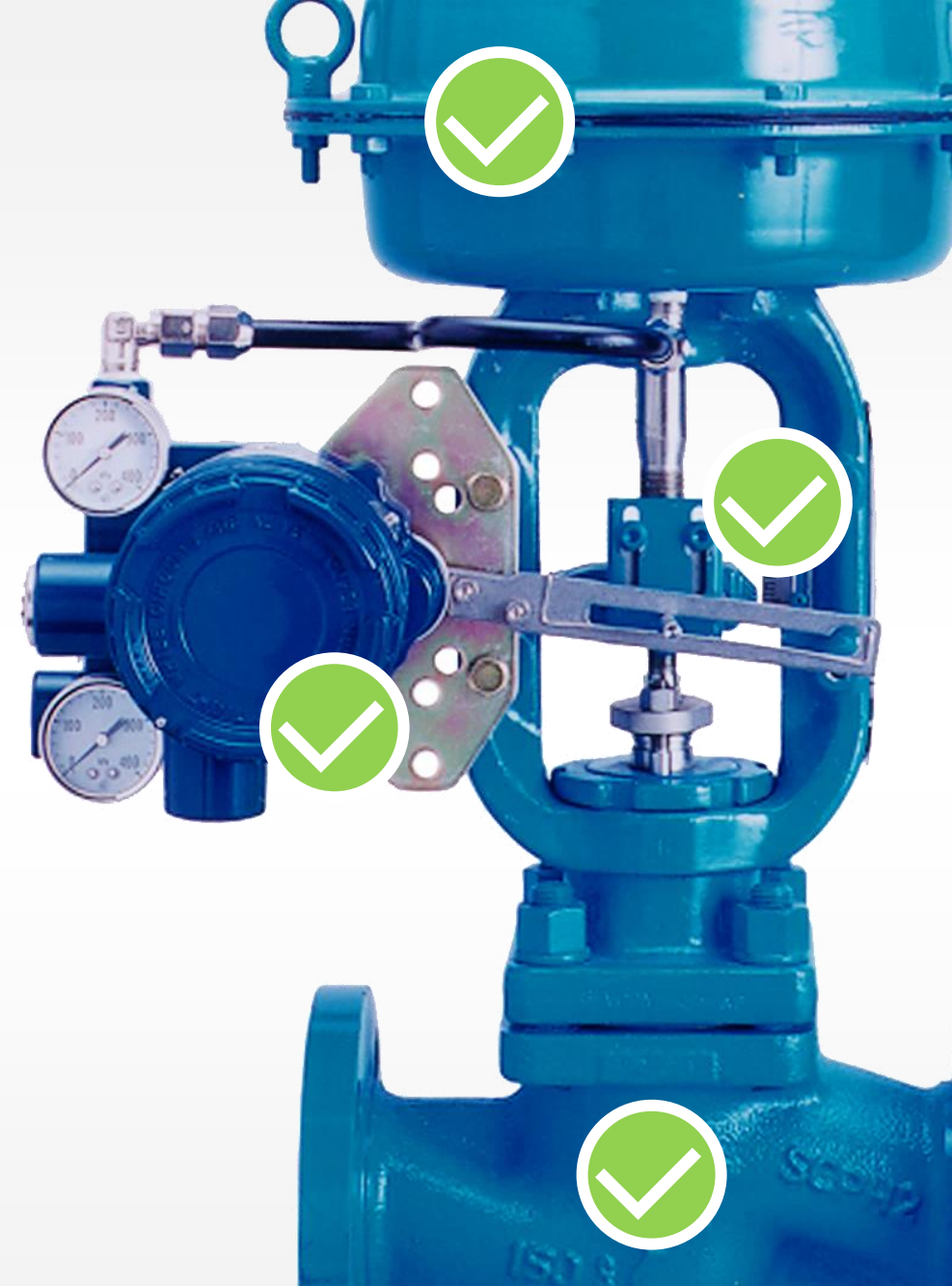

Control Valve Diagnosis

AVP will provide useful data for analysis



Cost Reduction

Spare Parts Reduction

Energy Savings

Before



If you need to change positioner spec. later on site...

Stabilizer & Pilot relay



To change actuator size

Replace stabilizer and pilot relay

To change flow characteristics

Replace span unit and springs

To change range

Replace span springs

Zero springs



Span springs



AVP



Connect to *CommStaff*

Change Settings

CommStaff
Field Communicator
Software



**SMARTER
WAY**

No Parts Replacement Required

To change the specification of AVP, just connect to *CommStaff* and change parameters

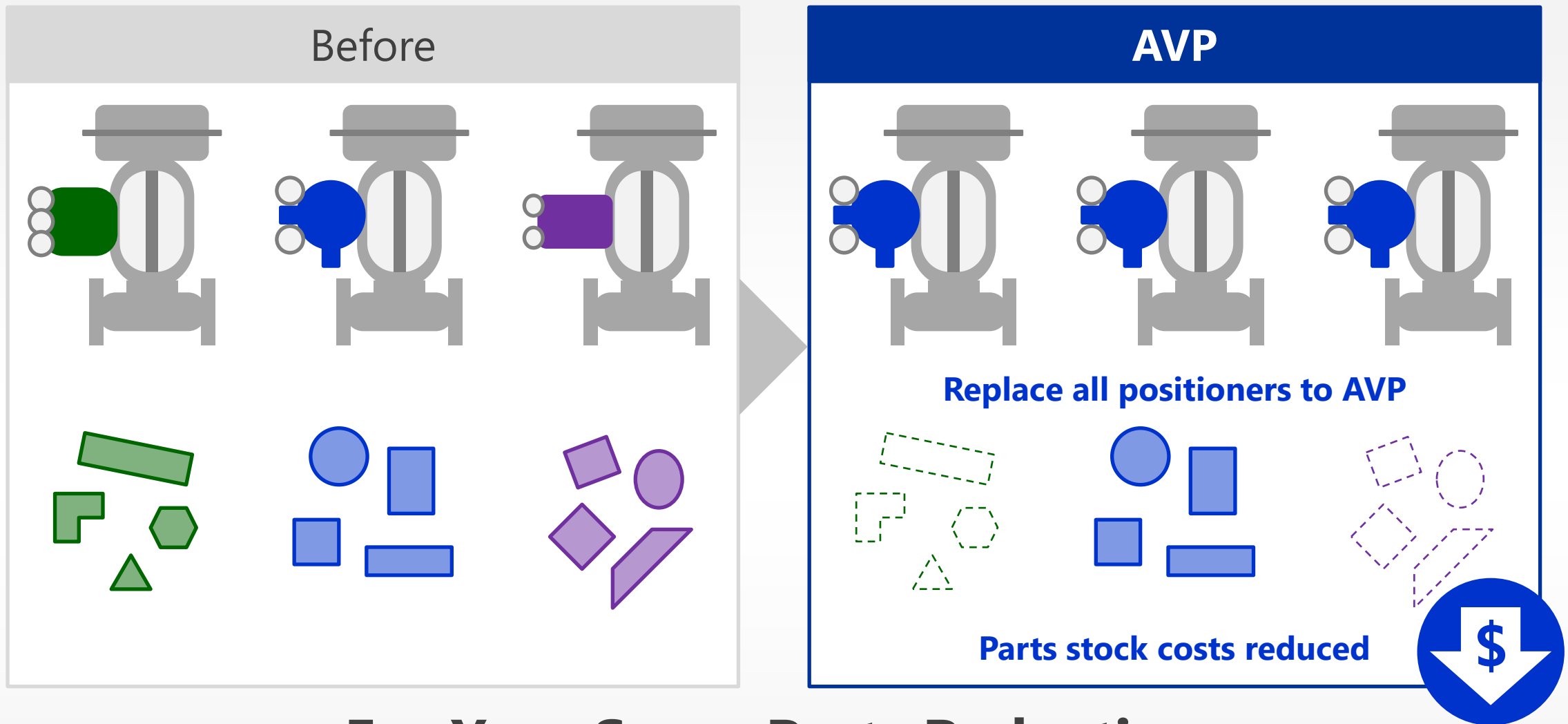

For Your Spare Parts Reduction

Replace all your positioners with AVP, you can reduce spare parts for greater cost reduction

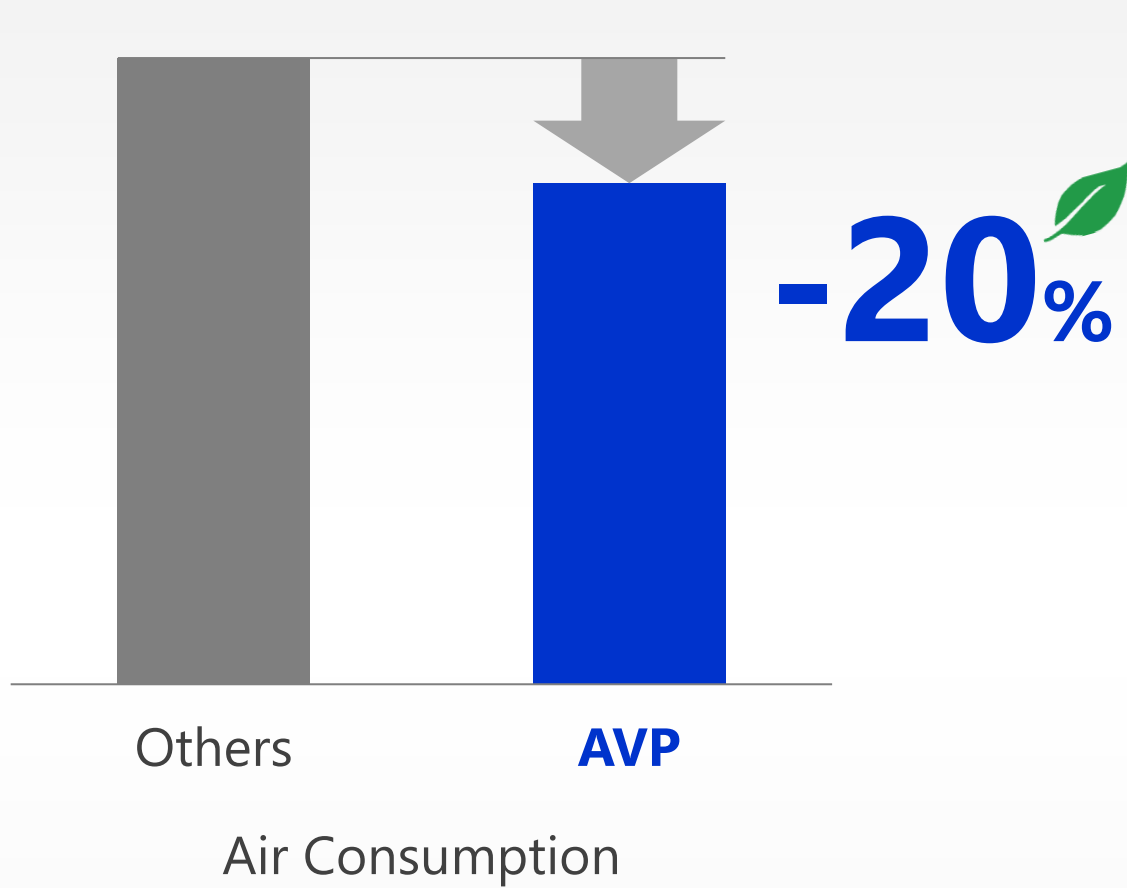

Energy Savings by Less Air Consumption

AVP has 20% less air consumption than other positioners



Higher Reliability



Easy Operation



Cost Reduction

AVP, for Your Smarter Choice

azbil

Thank You

SMART VALVE POSITIONER



APPENDIX

Contact Us:



VTL TECH CO., LTD.

SOLUTION PROVIDER FOR INDUSTRIES

19A Cong Hoa Street, Bay Hien Ward, Ho Chi Minh City, Vietnam

Tel: (+84-28) 3811 0510 / 11

Fax: (+84-28) 3811 0512

Website: www.vtltech.com.vn

Email: info@vtltech.com.vn

